

CATALOGUE NO.	MATERIAL	TURN ANGLE	INSTALATION DIMENSION [mm]		MIN. DOOR WIDTH
			X	Y	
4.401.001	Steel zinc plated	90°	140	176	399
		105°	120	162	385
4.401.001SN	Stainless steel	120°	110	149	372
		135°	100	144	367

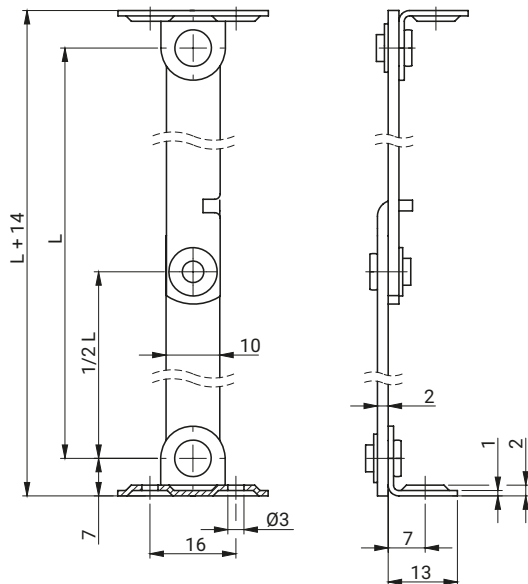

CATALOGUE NUMBER	Dimension L [mm]	MATERIAL
4.401.200	292	Steel zinc plated
4.401.201	252	
4.401.202	202	
4.401.203	135	
4.401.200SN	292	Stainless steel
4.401.201SN	252	
4.401.202SN	202	
4.401.203SN	135	