

The lock automatically returns to the closed position

TYPE OF LOCK	INSERT [X]	COMPONENTS	MATERIAL	FINISH [C]
				Chrome
M22-6	 T8	Housing, Insert, Latching cam	ZAMAK 5	01

**How to order:**

Type of lock  
Type of insert  
Finish [C]

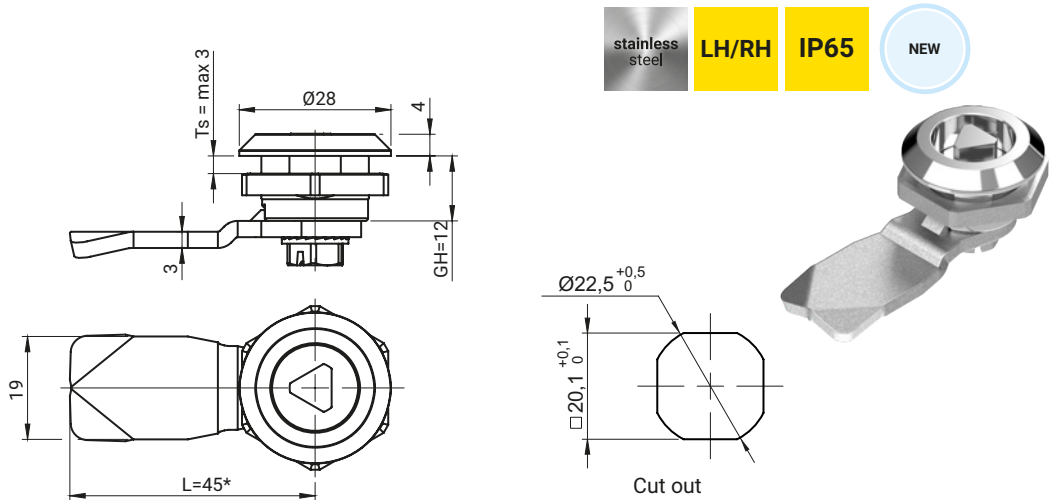
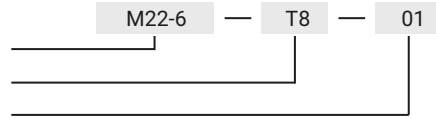

TYPE OF LOCK	TYPE OF MATERIAL AND PROTECTIVE COATING HOUSING AND INSERT [C]					INSERT [X]								
	ZAMAK 5			Stainless steel										
M22-10	Chrome 01	Zinc plated 03	RAL9005 04	304 9.1	316 -	T7	T8	KW6	KW7	KW8	D3	D5	HEX6	HEX8W

**How to order:**

Type of lock  
Pin type [X]  
Finish [C]  
Type of material / surface finish [C]

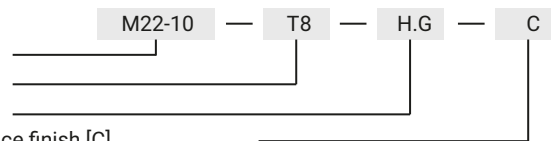

**meaning:**

C - designation of material and surface finish  
H.G - the cam unbending dimension, cams range  
Ts - door thickness

The lock is fitted with cams from the group: 12, 14, 17, 17A, 18, 32, 34, JK1-16018, JK2-16018, J-6000.03, J-6000.04, JK-1610.01, JZ-002 (pages 1C-10 to 1C-23)