

stainless steel
IP65
LH/RH
  
 for stainless steel version

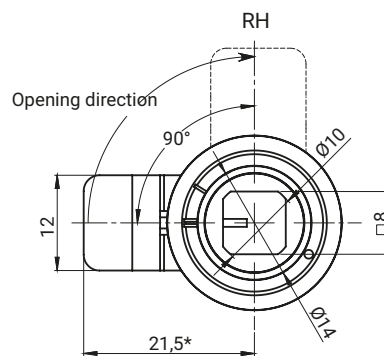
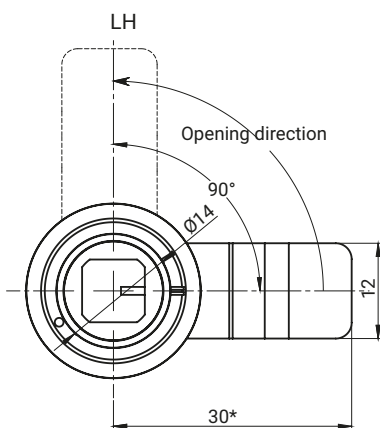
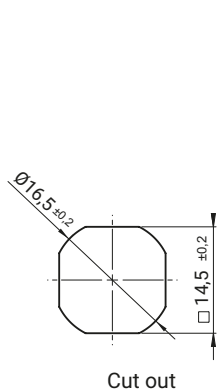
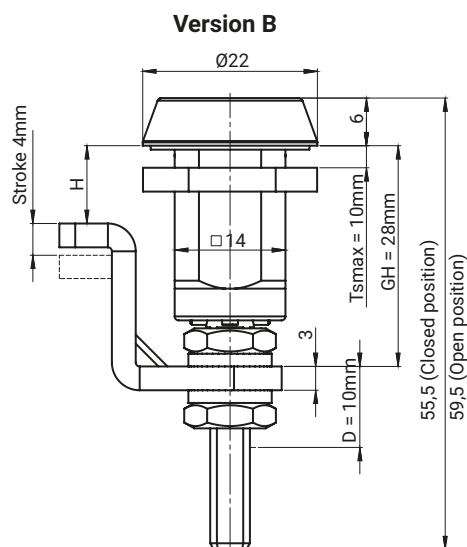
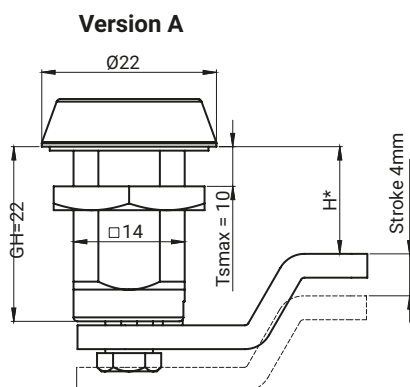

### HEIGHT ADJUSTMENT H CAM FOR LOCK IN VERSION B

CAM	H
1 Bended 18mm	10 - 20
	46 - 56
2 Bended 9mm	19 - 29
	37 - 47
3 Straight	28 - 38

The lock has **IP65**.  
 The lock has double pressure.  
 The lock is fitted with the key 2.KLKW8.001 (pg. 2A-130, 133, 136).  
**D** - the range of latch adjustment M16SD22 type B.  
**Ts** - the thickness of sheet steel.  
 In lockM16SD22 type B bended can be fitted double sided.

TYPE OF LOCK	ELEMENTY SKŁADOWE	MATERIAL
M16SD22	Housing, Insert, Cam	Stainless steel

### How to order:

Type of lock: M16SD22  
 Type of insert: KW8  
 version of lock + opening direction A, B; L- left, R-right: BL  
 The height of cam: 22  
 - for version A: H=13, 22, 31, 40  
 - for version B: Cam 1, 2, 3 (chart above)

### INSERTS [X]

