

Lock 2.516 with height adjustable cam

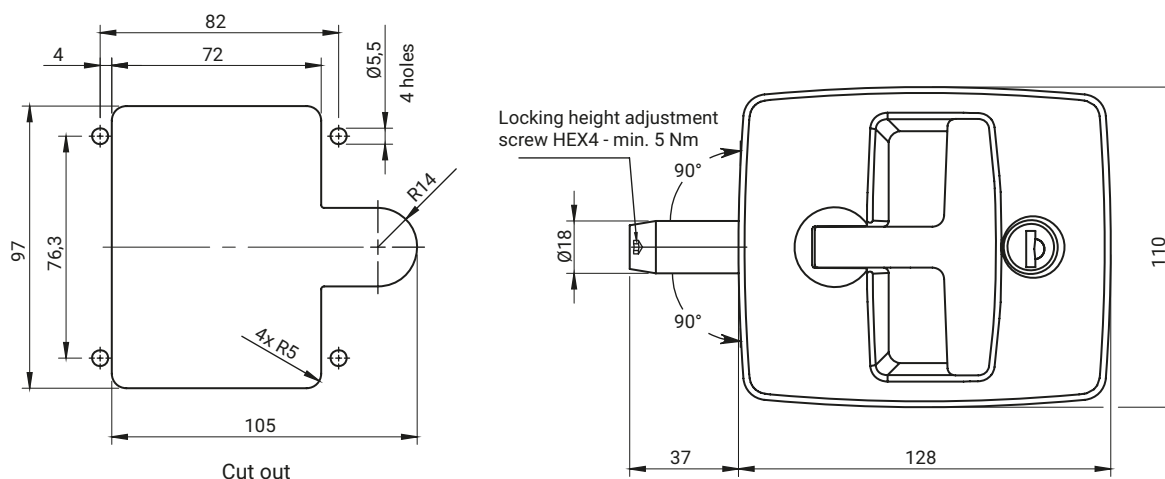
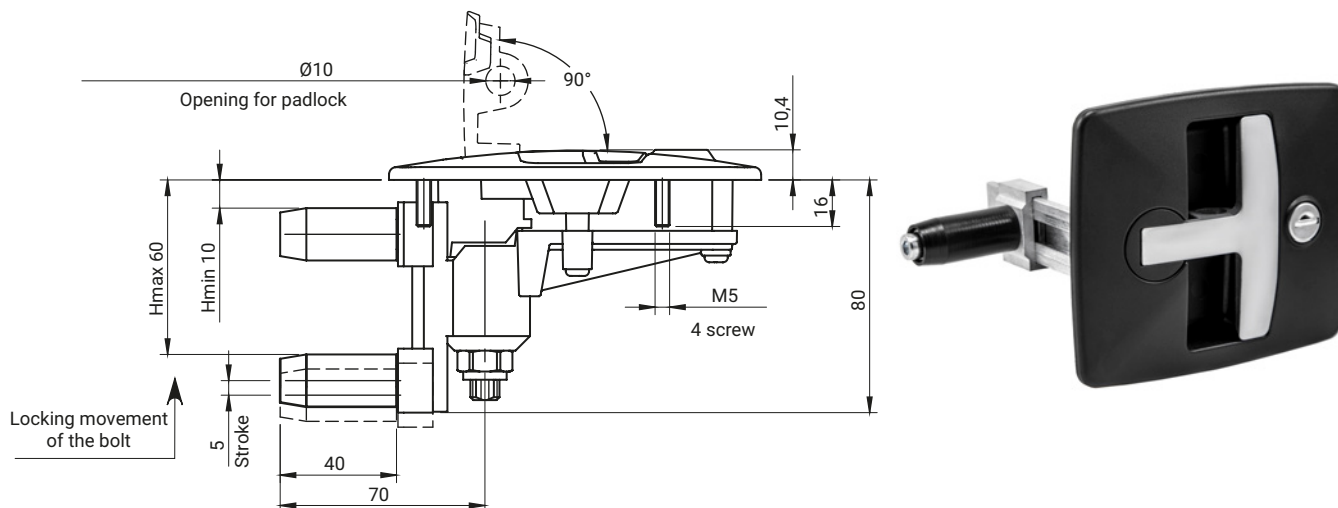

Sealing of lockable doors by folding the lock handle into the lock body.
The locking height (dimension H) is adjustable from 10 to 60 mm.
Locking height is adjusted when the lock is installed and locked with the HEX 4 key
- Recommended tightening torque for the adjusting screw: 5 Nm.

CATALOGUE NO.	COMPONENTS	MATERIAL	FINISH [C]		CYLINDER PROFILE	
			Chrome	RAL9005	Key code	
2.516.001	Housing, Lever Roller	Polyamide PA6 GF	-	07	Different code RK	1333
	Handle	ZAMAK 5	01	04		
	Bolt, Lever Bushing	ZAMAK 5	-	-		

INSERTS [X]				FINISH [C]	
				Chrome	RAL9005*
D5	T9	KW8	S	01	04

How to order:

Catalogue no.

Key code / Type of insert [C]
where: C - type of insert surface finish

Housing finish [C]

Handle finish [C]

* other colours on request

